

## Field Functional Tests

You *must* perform a field functional test after any of the procedures in this chapter are performed. The applicable test is specified after each section in this chapter. Appendix D, Field Functional Tests, contains complete test instructions.

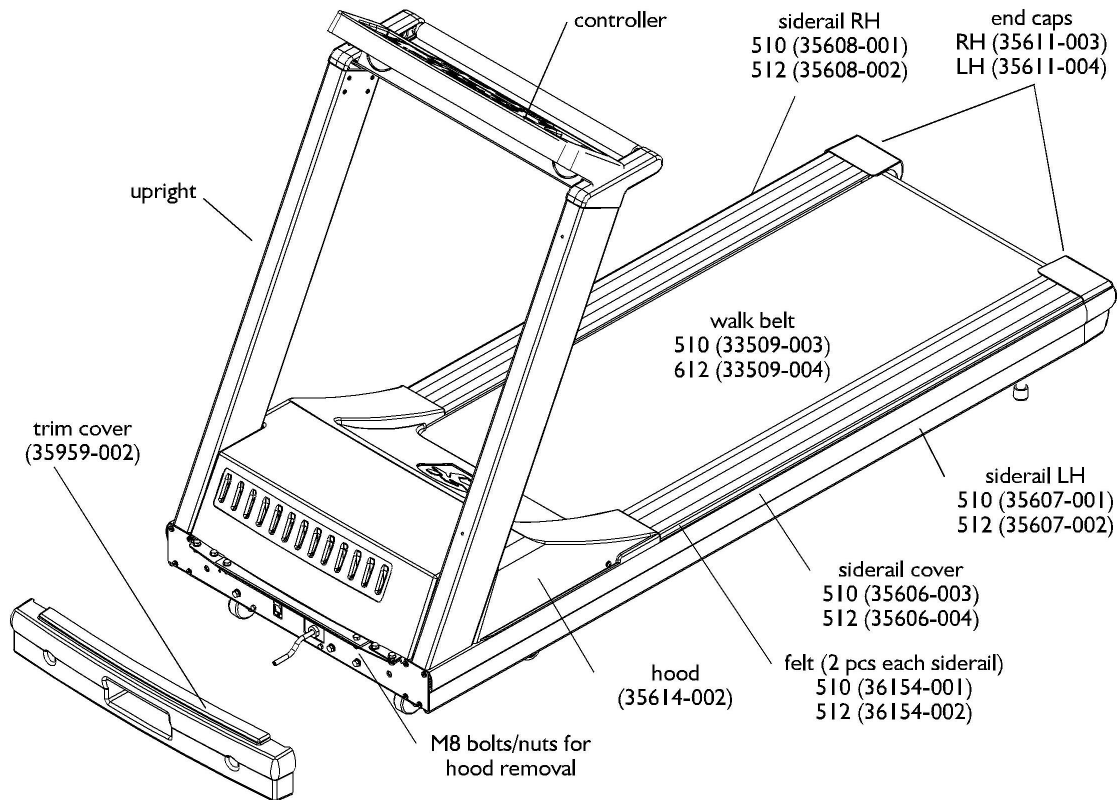

**The VSD PCBA generates high voltage, which is present whenever DS4 and DS5 are illuminated. Do not touch the VSD PCBA until DS4 and DS5 have gone out. Resistors on the PCBA bleed off the high voltage in approximately two minutes.**



## Removing Treadmill Hood

1. For your convenience in working, elevate the treadmill to its maximum height if possible.
2. Turn off the circuit breaker on the treadmill and unplug the treadmill from the power outlet.



**To prevent high voltage electrical shock: Before working on or around any electrical or mechanical component under the hood, wait at least two minutes from the time you unplug the power cord.**

International units: Disconnect the power cord from the configuration plate.

3. Use a flat blade screwdriver to turn the two 1/4-turn fasteners on the front trim cover.
4. Remove the two 8mm bolts/nuts/washers located under the front trim cover at the front of the hood.
5. Remove the two M6 button head screws located on the side of the hood

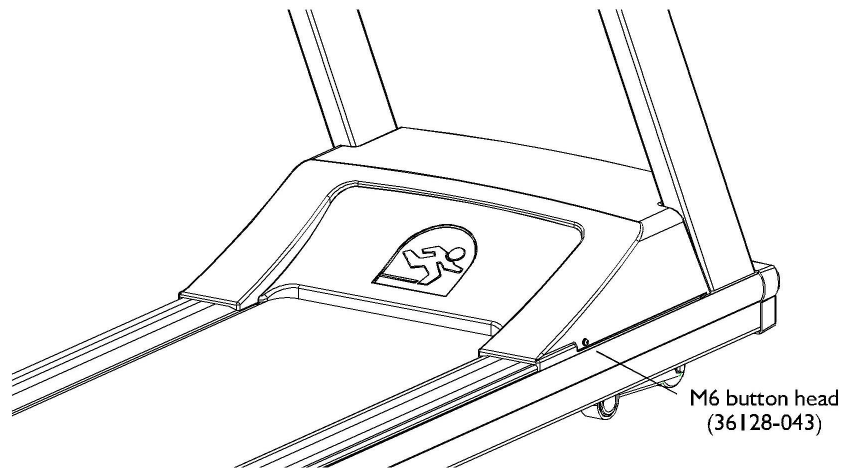
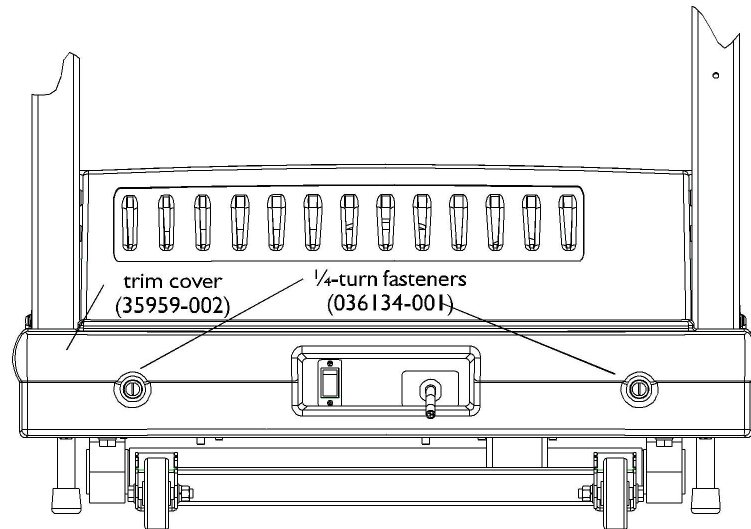

6. Grasp the hood cover at the front and back center. Pull and lift to remove.
  - Recommended: vacuum hood area before replacing hood and applying power. Be careful near VSD card cage. Do not damage VSD board.
7. To replace the hood, follow steps 3-6 in reverse order.

## Field Functional Test

To verify that the treadmill is operating properly, perform Field Test No. 1. See Appendix D, *Field Functional Tests*, for specific instructions.

## Replacing the Configuration Plate Assembly

On North American units, the configuration plate module includes the power cord, which is attached to the plate. On international units, the power cord is removable and is not part of the configuration plate module.

1. Turn off the treadmill circuit breaker, then remove the power cord from the power outlet.
2. Remove the hood as previously described.
3. Remove the two 6mm hex head screws that attach the power cord ground wires to the headframe. (They are located in the center of the headframe. The ground is marked with a ground symbol.)
4. Unplug the connectors from the VSD board (North American units: 3 wires (115v) or 2 wires (230v)), International units: 2 wires). Note the wire colors and connection points.
5. Remove the four 6mm hex-head screws holding the configuration plate to the front of the headframe and two 6mm hex head screws holding the configuration plate to the bottom of the headframe.
6. Replace the configuration plate module following Steps 2 through 5 in reverse order.

